



Mercedes-Benz

Accessories

Installation Instructions

Mobile telephone cradle
Siemens S 65, SP 65 and SK 65

© 2007, Daimler AG

05/05
03F053-05

Contents

- Fitting the mobile telephone cradle ▷ 3
- Inserting the mobile telephone ▷ 4
- Hands-free mode display ▷ 5
- Removing the mobile telephone ▷ 6
- Detaching the mobile telephone cradle ▷ 6
- Operating instructions ▷ 7

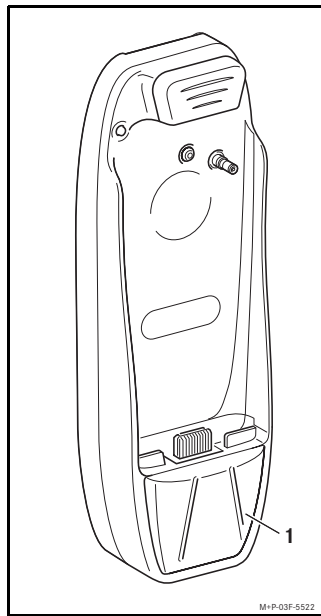

M-P-03F-5522

Fitting the mobile telephone cradle

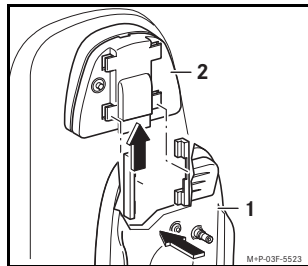

M-P-03F-5523

Press the cradle (1) into the catches on the pre-installed retainer (2), keep the cradle (1) pressed and slide it upwards until it clicks into place.



Validity

These installation instructions are valid for vehicles with

- mobile-phone fittings, including an interface (code 386) or
- Mercedes-Benz mobile phone (code 388) or
- Mercedes-Benz hands-free system for the multi-function steering wheel

together with a Siemens S 65, SP 65 and SK 65 mobile phone.

Parts included

- (1) Mobile telephone cradle

Notes

Please contact a qualified specialist workshop if you encounter difficulties when fitting the mobile telephone cradle.

Mercedes-Benz recommends that you use a Mercedes-Benz Service Centre for this purpose.

The manufacturer reserves the right to change technical details from those shown in the illustrations contained in these installation instructions.

These installation instructions also refer to the vehicle Owner's Manual. Please keep it handy for reference.

These installation instructions show the Mobile telephone cradle are fitted, using the Siemens S 65, as an example. Follow the same procedure when fitting the Mobile telephone cradle for Siemens SP 65/SK 65 mobile phone.

Inserting the mobile telephone

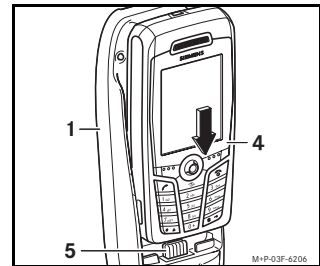

M-P-03F-6206

1. Slide the lower section of the mobile phone (4) onto the connector (5) of the cradle (1).

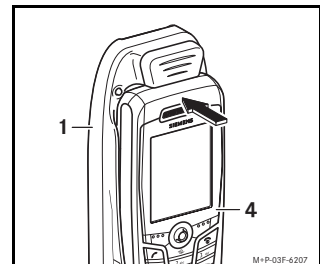

M-P-03F-6207

2. Press the upper part of the mobile telephone (4) into the cradle (1) until the mobile telephone (4) engages in the cradle (1).

Hands-free mode display

For the hands-free system to function properly, the mobile telephone has to be fitted and switched on, and hands-free mode has to be activated.

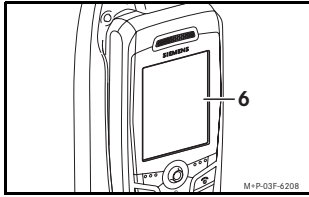

A message appears on the display (6) of the mobile telephone (please refer to the operating instructions of the mobile telephone for the exact wording of the message). If this is not the case, remove the mobile telephone (refer to the section entitled "Removing the mobile telephone") and re-insert it.

Removing the mobile telephone

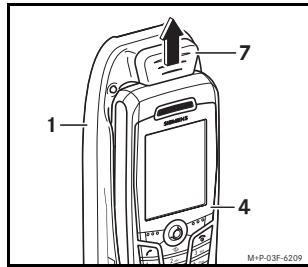

1. Slide the locking tab (7) upwards and pull the top of the mobile telephone (4) out of the cradle (1). Then take the mobile telephone (4) up and out of the cradle (1).

Detaching the mobile telephone cradle

1. Remove the mobile telephone from the cradle (please refer to the section entitled "Removing the mobile telephone").

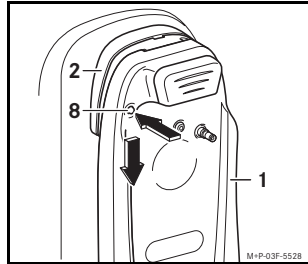

2. Press and hold the release button (8). Slide the cradle (1) downwards and remove it from the pre-installed retainer (2).

Operating instructions

1. Please refer to your Mercedes-Benz vehicle Owner's Manual for operating instructions regarding the mobile telephone cradle in connection with the factory-installed hands-free system (code 386/388).
2. The following operating instructions (points a, b, and c) only refer to the retrofitted accessory solution of the Mercedes-Benz hands-free system for the multi-function steering wheel. The buttons "+" and "-" mentioned in the description below refer to the multi-function steering wheel.
 - General operation of the hands-free system: Operation of the hands-free system via the multi-function steering wheel and how to set the run-on time are explained in the vehicle Owner's Manual.
 - Displaying complete names or telephone numbers (this function depends on the vehicle model): The "+" button must be pressed to display the full name of the caller. The "-" button must be pressed to display the entire telephone number of the caller.
 - Adjusting the volume of a conversation: During a telephone call, the volume can be increased with the "+" button and decreased with the "-" button.