



Mercedes-Benz

Accessories

Installation Instructions

Mobile telephone cradle
Motorola RAZR V3 and V3i

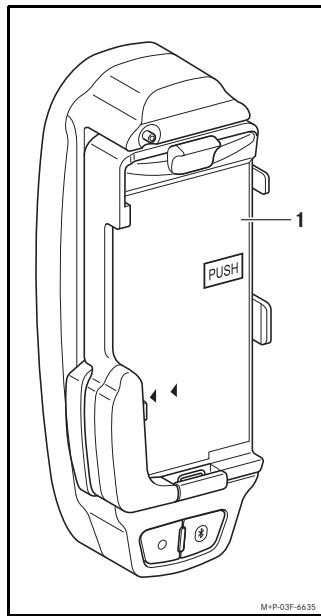

GB

Validity

These installation instructions are valid for vehicles equipped with the following:

- mobile phone fitting with interface (code 386) or
Mercedes-Benz mobile phone (code 388) or
Mercedes-Benz hands-free system for the multi-function steering wheel

Each in combination with the Motorola RAZR V3 and V3i mobile phones.

Parts included

- (1) Mobile phone cradle

Notes

Please contact a qualified specialist workshop if you encounter difficulties when fitting the mobile phone cradle.

Mercedes-Benz recommends that you use a Mercedes-Benz Service Centre for this purpose.

The manufacturer reserves the right to change technical details from those shown in the illustrations contained in these installation instructions.

These installation instructions also refer to the COMAND and Audio Operating Instructions and/or the vehicle Owner's Manual and the mobile phone operating instructions. Please keep them handy for reference.

At high outside temperatures, the cradle can become very hot when in operation, as is the case with the vehicle interior itself.

© 2007, Daimler AG

02/07
03F005-07

Contents

- Fitting the mobile phone cradle > 4
Inserting the mobile phone > 5
Pairing the mobile phone with the cradle > 7
Connecting the mobile phone to the cradle > 9
Manually connecting the mobile phone with the mobile phone cradle > 11
Automatically disconnecting the Bluetooth® connection between the mobile phone and the mobile phone cradle > 12
Manually disconnecting the Bluetooth® connection between the mobile phone and the mobile phone cradle > 12
Removing the mobile phone > 13
Detaching the mobile phone cradle > 14



Risk of accident

If it is legally permissible to use the phone while driving, only do so when traffic conditions allow for it. You may otherwise become distracted from the traffic, which may lead to an accident in which you or others may become injured.

Please comply with the legal regulations of the country in which you are driving when you are using the telephone inside the vehicle.

For safety reasons, only use the hands-free system to make calls while driving.

When you are using the telephone via the hands-free system, drive with extra caution, close all windows and try to eliminate background noise.

Please pull over or park the car if you do not wish to use the hands-free system to make a call. Do not stop the vehicle or park where it is prohibited to do so.

Fitting the mobile phone cradle

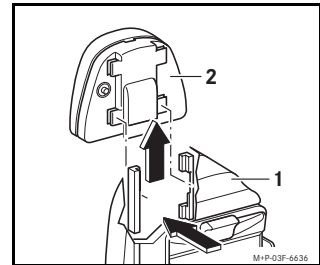

Press the cradle (1) into the catches of the bracket (2) and push it upwards until it audibly engages.

Inserting the mobile phone

Notes

Close the mobile phone before placing it in the cradle.

The mobile phone should be placed in the mobile phone cradle to charge the batteries and to establish a connection to the external aerial. After a Bluetooth® connection has been established, it is possible to use the mobile phone via the vehicle's operating system/on-board computer within a distance of 30 ft (10 metres), even if the mobile phone is not inserted in the cradle.

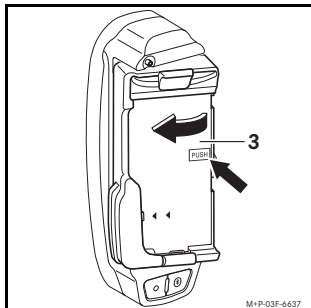

1. Press the cover (3). It folds up automatically.

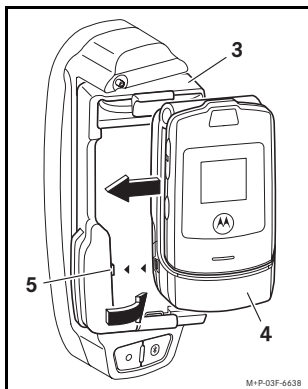

2. Slide the mobile phone (4) in, as illustrated. When doing so, make sure that:
 - the connector (5) on the mobile phone (4) engages into place
 - you do not press the lateral buttons on the mobile phone (4).
3. Fold the cover (3) back down until it engages into place.

Pairing the mobile phone with the cradle

Note

Pairing is only possible while the mobile phone is not inserted in the mobile phone cradle.

1. Turn the ignition key to position 1 or 2. (Please refer to the vehicle Owner's Manual.)

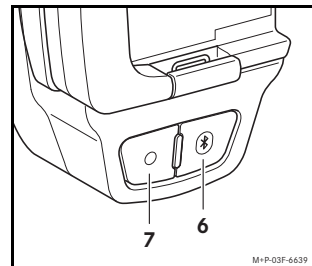

2. Press the Bluetooth® button (6) for approx. 2 seconds. The LED (7) flashes rapidly. The mobile phone cradle switches to Discovery Mode and can be recognised by the mobile phone. *MB V3 Cradle* appears on the mobile phone display to indicate the mobile phone cradle.
3. Select the following on the mobile phone: "Menu" → "Connection" → "Bluetooth Link" → "Setup" → "Power: ON". (Please refer to the mobile phone operating instructions.)
4. Select the following on the mobile phone: "Bluetooth Link" → "Hands-free: Search for devices". (Please refer to the mobile phone operating instructions.) The mobile phone begins searching for the mobile phone cradle. When the mobile phone finds the cradle, "*MB V3 Cradle*" appears in the mobile phone display.

5. Select "*MB V3 Cradle*" on the mobile phone and confirm with "Yes". (Please refer to the mobile phone operating instructions.) After confirmation, a passkey request appears on the display.

6. Enter passkey 62872 on the mobile phone. The LED (7) lights up continuously after the passkey is entered. The mobile phone is now paired with the mobile phone cradle.

Note

A maximum of 4 mobile phones can be paired with the mobile phone cradle, but only one can be connected at a time. If a fifth mobile phone is paired with the mobile phone cradle, the mobile phone that was paired first is deleted.

Connecting the mobile phone to the cradle

After the mobile phone is paired, the connection between the mobile phone cradle and the mobile phone is established.

Notes

If the mobile phone cradle and the mobile phone are not connected automatically, the connection can be established manually (see ▷ 11).

There is always only one mobile phone connected with the cradle.

With the ignition key in position 1 or 2, the mobile phone cradle automatically searches for the mobile phone connected last and establishes a connection to this phone. If the mobile phone connected last is not found, the mobile phone cradle searches for the previously connected mobile phones.

The mobile phone uses more power when operating with Bluetooth®. Therefore, the mobile phone should always be inserted in the cradle, when possible. The mobile phone battery is charged when the ignition key is in position 1 or 2.

Text messages (SMS) can be accessed via COMAND or the vehicle's operating system/on-board computer. However, they cannot be written or sent via COMAND or the vehicle's operating system/on-board computer.

The mobile phone cradle does not support the holding and transferring of calls. Depending on the mobile network provider, these functions can be set up on the mobile phone. (Please refer to the mobile phone operating instructions.) While a call is in progress, an incoming call is indicated by a signal tone.

Muting is not available in the control system of the following vehicle model series:

- M-Class, model series W163, date of manufacture from 09/2004 onwards
- C-Class, model series 203, date of manufacture from 09/2003 to 04/2004
- CLK-Class, model series C209, date of manufacture from 09/2003 to 04/2004
- SL-Class, model series R230, date of manufacture from 09/2003 to 04/2004

Not every ring tone can be issued by COMAND or the vehicle's operating system/on-board computer.

While a connection between a mobile phone and the mobile phone cradle is active, a Bluetooth® symbol appears on the display. The name of the mobile network provider is not displayed.

Manually connecting the mobile phone with the mobile phone cradle

Note

Before being manually connected, the mobile phone must be paired with the mobile phone cradle (see ▷ 7).

The Bluetooth® connection can be established manually as follows:

For S-Class vehicles, W/V 221, and CL-Class vehicles, C 216:

- With the COMAND controller, select "Tel" → "Tel" → "Telephone". (Please refer to the vehicle Owner's Manual.)

For all other vehicle model series:

- Press the **TEL** button. (Please refer to the COMAND or Audio Operating Instructions.)

Note

The Bluetooth® connection remains active within a range of approx. 30 ft (10 metres) from the mobile phone cradle. Incoming calls are taken via the hands-free system. Therefore, the connection between the mobile phone and the mobile phone cradle should be disconnected manually when you leave the vehicle (see ▷ 12).

Automatically disconnecting the Bluetooth® connection between the mobile phone and the mobile phone cradle

The connection between the mobile phone and the mobile phone cradle is automatically disconnected beyond the reception range of approx. 30 ft (10 metres).

Note

After the Bluetooth® connection between the mobile phone and the mobile phone cradle has been disconnected automatically, an active call will automatically be connected to the hands-free system when you approach the vehicle.

Manually disconnecting the Bluetooth® connection between the mobile phone and the mobile phone cradle

The Bluetooth® connection can be manually disconnected as follows:

For S-Class vehicles, W/V 221, and CL-Class vehicles, C 216:

- With the COMAND controller, select "Tel" → "Tel" → "Telephone off". (Please refer to the vehicle Owner's Manual.)

For all other vehicle model series:

- Press the **TEL** button for approx. 3 seconds. (Please refer to the COMAND or Audio Operating Instructions.)

On the mobile phone

- (Please refer to the mobile phone operating instructions.)

Notes

During an active call, the connection between the mobile phone and the mobile phone cradle can only be disconnected on the mobile phone. (Please refer to the mobile phone operating instructions.)

After the Bluetooth® connection has been manually disconnected, an active call can be connected to the vehicle by pressing the **TEL** button. (Please refer to the COMAND or Audio operating Instructions.)

Removing the mobile phone

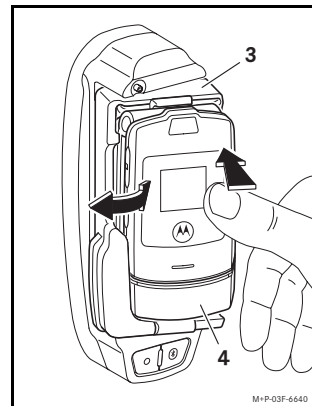

1. Press the cover (3). It folds up automatically.

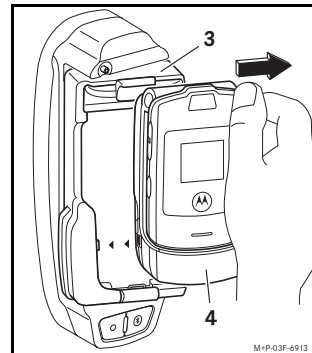

2. Take the mobile phone (4) out from the side without pressing the lateral buttons.
3. Gently fold the cover (3) back down until it engages into place.

Detaching the mobile phone cradle

1. Take the mobile phone out of the cradle (see ▷ 13).

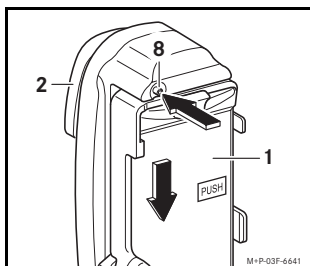

2. Press the release button (8), slide the cradle (1) downwards and remove it from the bracket (2).