



Mercedes-Benz

Accessories

Installation Instructions

Mobile phone bracket
Sony Ericsson W800, W800i and W810i

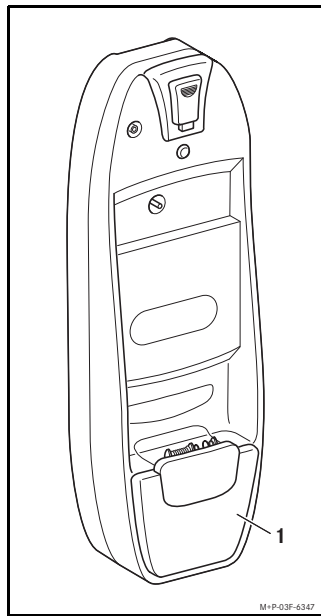

GB

Validity

These installation instructions are valid for vehicles equipped with the following:

- mobile phone fitting with interface (code 386) or
- Mercedes-Benz mobile phone (code 388) or
- Mercedes-Benz hands-free multi-function steering wheel

in conjunction with a Sony Ericsson W800, W800i or W810i.

Parts included

- (1) Mobile phone cradle

Notes

Please contact a qualified specialist workshop if you encounter difficulties when fitting the mobile phone cradle.

Mercedes-Benz recommends that you use a Mercedes-Benz Service Centre for this purpose.

The manufacturer reserves the right to change technical details from those shown in the illustrations contained in these installation instructions.

These installation instructions also refer to the COMAND and Audio Operating Instructions, the vehicle Owner's Manual and the mobile phone operating instructions. Please keep them handy for reference.

© 2007, Daimler AG

08/07
03F049-07

Contents

- Fitting the mobile telephone bracket/Inserting the mobile telephone ▷ 4
- Switching to hands-free mode ▷ 5
- Transferring the telephone book to the operating system/on-board computer ▷ 5
- Removing the mobile phone/ Detaching the mobile phone bracket ▷ 7



Risk of accident

If it is legally permissible to use the mobile phone while driving, only do so when traffic conditions allow for it. You may otherwise become distracted from the traffic, which may lead to an accident in which you or others may become injured.

Please comply with the legal regulations of the country in which you are driving when you are using the mobile phone inside the vehicle.

For safety reasons, only use the hands-free system to make calls while driving.

When you are using the mobile phone via the hands-free system, drive with extra caution, close all windows and try to eliminate background noise.

Please pull over or park the car if you do not wish to use the hands-free system to make a call. Do not stop the vehicle or park where it is prohibited to do so.

Fitting the mobile telephone bracket/ Inserting the mobile telephone

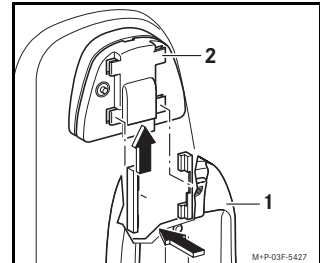

1. Press the cradle (1) into the catches of the bracket (2) and push it upwards until it audibly engages.

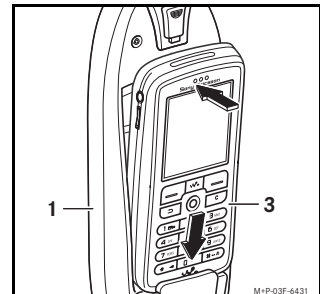

2. Insert the mobile phone (3) into the bracket (1) as illustrated.

Switching to hands-free mode

The use of a Bluetooth® headset is not possible in hands-free mode.

Valid for Sony Ericsson W800 and W800i

The mobile telephone switches to hands-free mode when switched on and inserted.

Valid for Sony Ericsson W8 10i

In order to connect to the Mercedes-Benz hands-free feature in the vehicle, the following settings have to be made:

1. Menu → General → Profiles → In car → More → select View and edit.
2. Accessory → New accessory → Add → select Car handsfree. This message appears: Profile updated: In car.

Transferring the telephone book to the operating system/on-board computer

The telephone book cannot be transferred under the following conditions:

- Remaining in Start-up menu.
- Music only is selected.

The Start-up menu setting has to be deactivated, refer to mobile telephone operator's manual.

Note

Access to the telephone book in the SIM card via the Mercedes-Benz hands-free feature is not possible. Telephone book entries in the SIM card must be copied to the telephone book in the mobile telephone, refer to mobile telephone operator's manual.

Notes on operation

Refer to COMMAND, audio or vehicle operation manual regarding the operation of the mobile telephone using the multi-function steering wheel and how to set the follow-up time.

The volume can be adjusted during a telephone call with **+** or **-**.

Depending on the service provider, some of the functions of the Mercedes-Benz hands-free feature cannot be used if the mobile telephone is operating with a pre-paid SIM card.

It is only possible to activate the suppression of call numbers on the mobile telephone, see mobile telephone operator's manual.

Only for vehicles with mobile telephone set-up with interface (Code 386) or Mercedes-Benz mobile telephone (Code 388)

A dialling shortcut function can be used on Mercedes-Benz audio systems with a number pad. With numbers 1 through 9, memory locations 1 through 9 in the telephone book can be accessed.

Memory locations 1 through 9 in the telephone book must be occupied, refer to mobile telephone operator's manual.

For example, if a telephone number is to be saved in location 1, it has to be selected on the number pad and then it can be renamed in the mobile telephone, refer to the mobile telephone operator's manual.

Removing the mobile phone/Detaching the mobile phone bracket

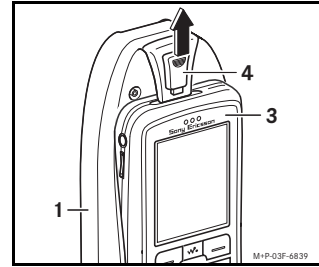

1. Slide the lock (4) upwards and remove the mobile telephone (3) from the holder (1).

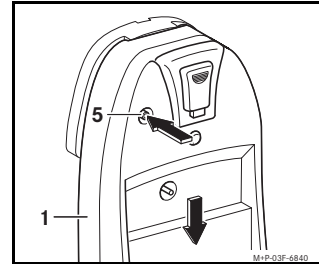

2. Press the release button (5), push the bracket (1) downwards and detach.